

2.0 mm HM Type A-25 Right Angle Female



SPECIFICATION

- Insulator Material: PBT 30% Glass filled UL 94 V-O
- Contact Material: Copper Alloy
- Shield Material: Copper Alloy
- Contact Plating:
 - Contact Area: Gold
 - Compliant Area: Matte Tin
 - Performance: Class 1: 500 cycles
 - Class 2: 250 cycles
- Shield Plating:
 - Contact Area: Gold
 - Compliant Area: Matte Tin
- Temperature Range: -55 C to +125 C
- Contact Resistance: 20 M Ω Max.
- Insulation Resistance: 10 M Ω Max.
- Working Current: 1.5 ADC (Signal)
- Test Voltage: AC 750 V Min.
- Compliant Section:
 - Insertion Force: 100 N per contact Max.
 - Withdrawal Force: 20 N per contact Min.
- Mating Force: .75 N per pin Max.
- Withdrawal Force: .15 N per pin Max.
- PCB Hole Size Requirements:
 - Drilled Hole Diameter: 0.7 ± 0.02 mm
 - Finished Hole Diameter: 0.6 ± 0.05 mm
- Recommended PCB Thickness: 1.6mm Min.
- IEC 61076-4-101 Standard

The **EZ met** Type A-25 female connector provides 110 contacts, and a multifunction cavity with pre-alignment guides to prevent improper loading. This connector is used in the J1 and J4 positions of the Compact PCI daughtercard.

ECS offers the Type A-25 connector either with or without mounting pegs. The connectors are also available with integrated upper ground return shields and lower ground return shields may be ordered separately. This connector is designed to be used by itself or with any Type B, C, L, M or N **EZ met** connector.

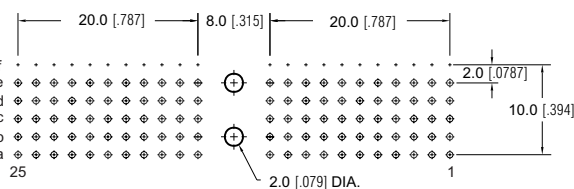
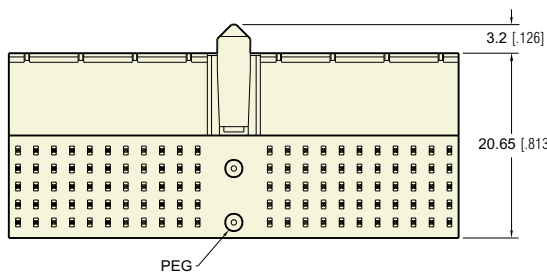
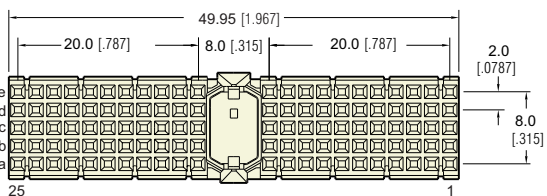

BOARD LAYOUT

PART NUMBERING



SERIES CODE
2mm Hard Metric Female

TYPE
A25

MOUNTING PEG
1= Without Peg
Blank = With Peg

UPPER SHIELD
0 = Without Upper Shield
1 = With Upper Shield

CONTACT LOADING
1 = A, B, C, D, E
2 = A, B, C, D
3 = A, B, C
4 = A, D, E
5 = B, D

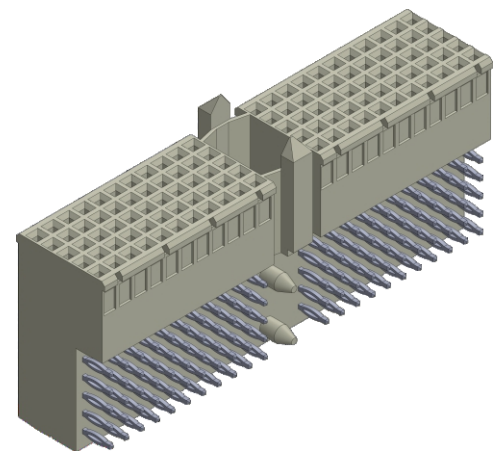
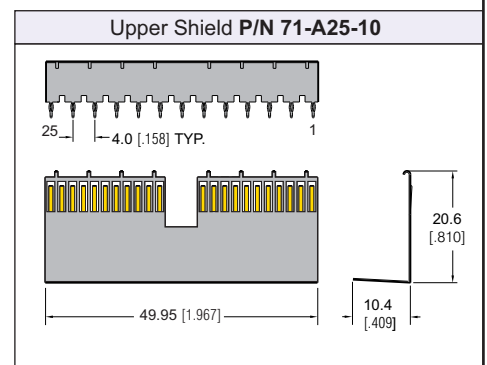
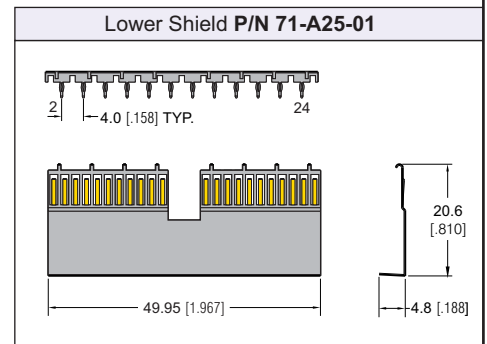

Dimensions are in mm [inch]