

## Specifications

1. Insulator Material: Thermoplastic, 94 V-O, UL Rated, color natural
2. Contact Material: Copper Alloy
3. Contact Plating: see part number system below
4. Current Rating: Ambient temp.= 20°C @ 15A, 70°C @ 11A, 100°C @ 7.5A
5. Contact Resistance: < 8 mΩ
6. Insulation Resistance: > 10<sup>6</sup> MΩ
7. Dielectric Strength: 3100V rms
8. Operating Temperature: -55°C to +125°C
9. IEC 60603-2 Connector

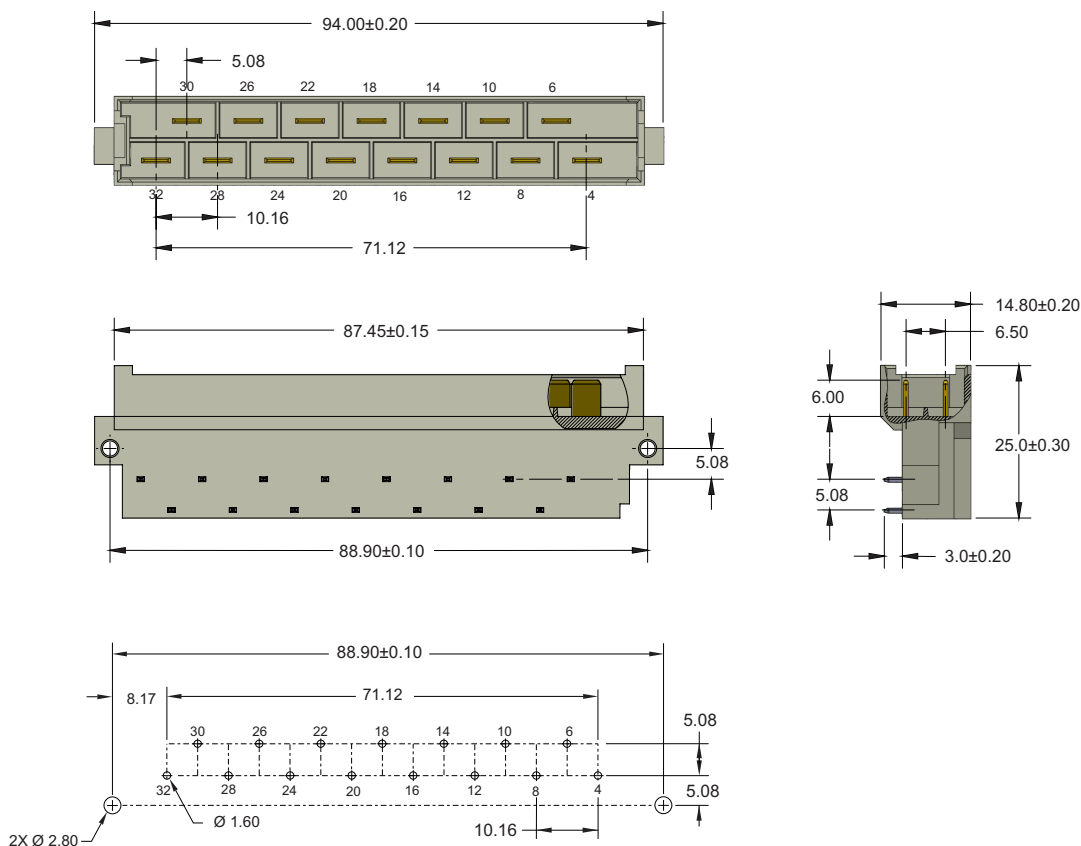
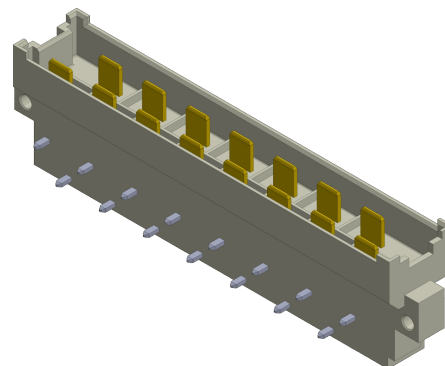

Recommended P. C. Board Layout

## PART NUMBERING

6H-151-X8XX

TOTAL CONTACT

5 = 15

EMLB/LMEB CONTACTS

2 = Standard Pin Loading  
 1 = EMLB / LMEB Contacts Required  
 (Consult Factory for EMLB / LMEB Contact Locations)

TAIL PLATING

1 = Tin  
 2 = Gold flash  
 3 = Gold plate 30μ"  
 4 = Gold plate 15μ"

MATING AREA PLATING

1 = Class 1  
 2 = Class 2  
 3 = Class 3