

Type M, Vertical Female DIN

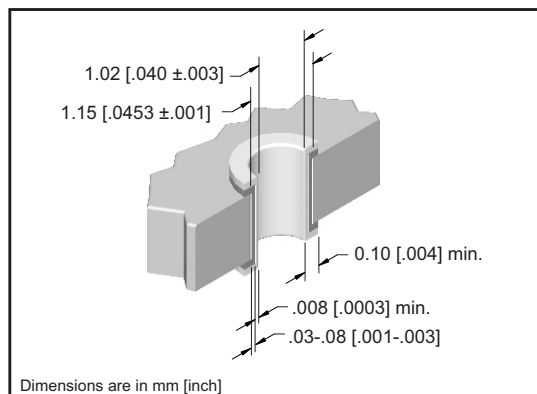

DIN 41612 SPECIFICATION	
Temperature Range	-65°C to +125°C
Insulator Material	PBT 30% Glass Filled UL 94 V-0 Rated
Contact Material:	Copper Alloy
Contact Plating / Performance	Level 1 ≥ 500 Mating Cycles Level 2 ≥ 400 Mating Cycles Level 3 ≥ 50 Mating Cycles
Contact Resistance	≤ 20m Ω
Insulation Resistance	≥ 10 ¹² m Ω at 100 VDC
Dielectric Strength	≤ 1000 VDC
Current Range at Ambient Temp. Of	+20C 3 Amp +70C 2 Amp +100C 1 Amp
Insertion Force (N)	≤ 70
Withdrawal Forces Per Contact (N)	≥ .15



DRILLED HOLE DIAMETER	PLATING THICKNESS	HOLE DIAMETER	PAD DIAMETER	INSERTION FORCE PER PIN	WITHDRAWAL FORCE PER PIN
1.15 [.0453]	Copper .03-.08 [.001-.003]	After Plating .040±.003	1.65 [.065]	40 lbs. Max.	10 lbs. Min.
	Tin .008 [.0003]min.				

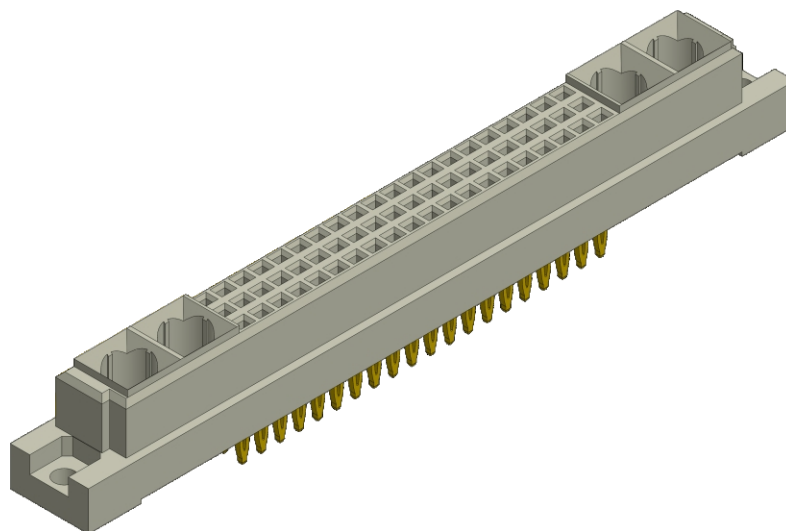

APPROVALS



Recognized under the recognized component Program of Underwriters Laboratories, Inc. File Numbers: E176234

IEC 60603-2 Standard

Bellcore GR 1217 CORE

Connectors are available that meet the requirements of Bellcore GR 1217-CORE. Please consult factory for ordering information.

Type M, Vertical Female DIN

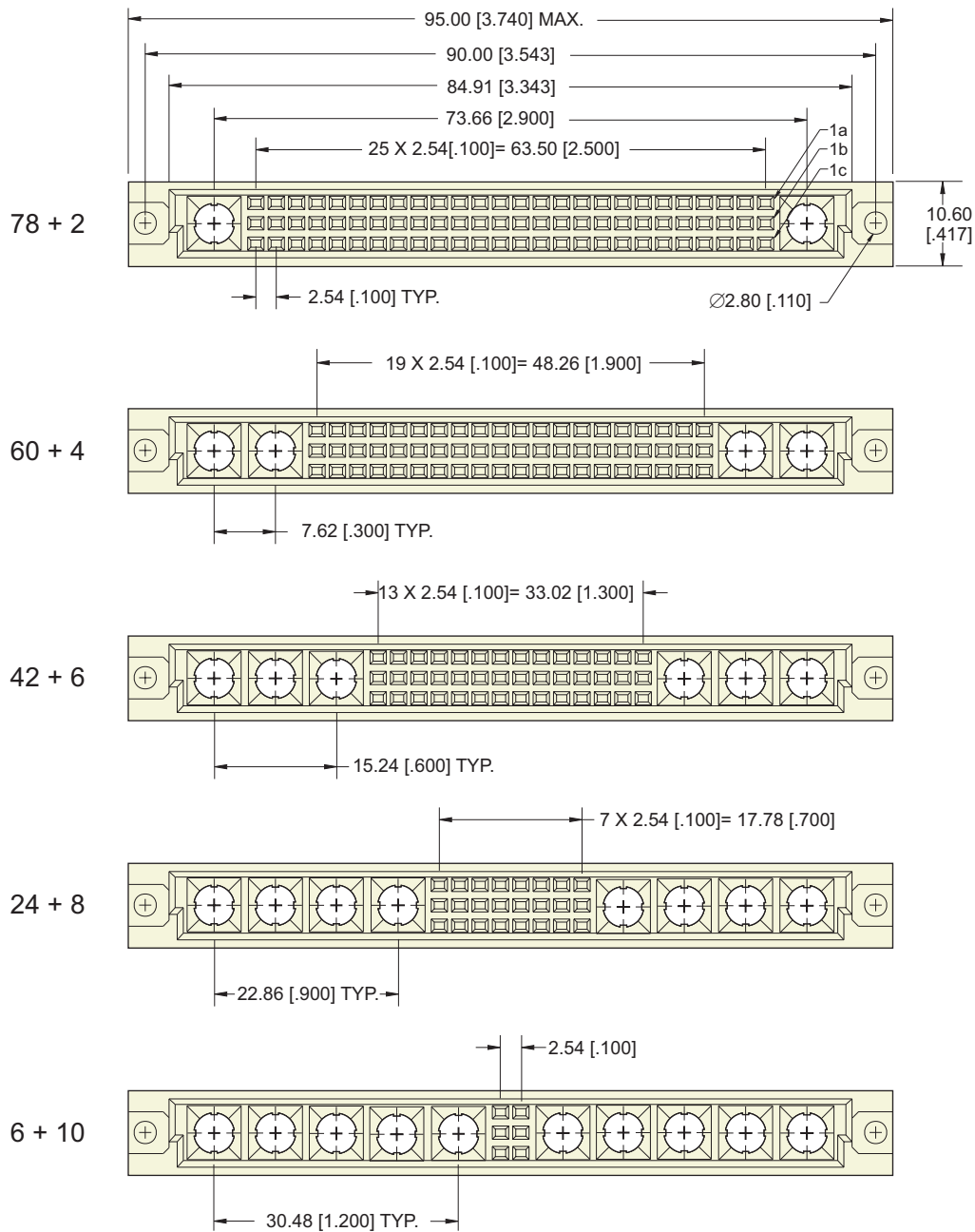

COAXIAL CONTACTS

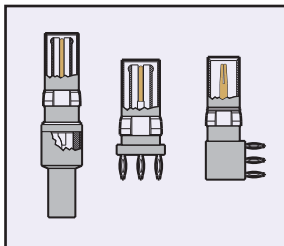

HIGH POWER CONTACTS

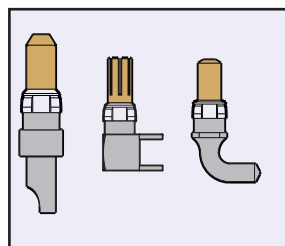

HIGH CURRENT CONTACTS

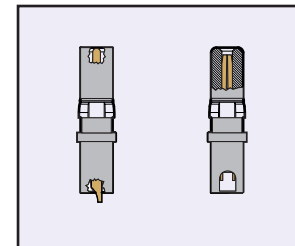

Type M, Vertical Female DIN

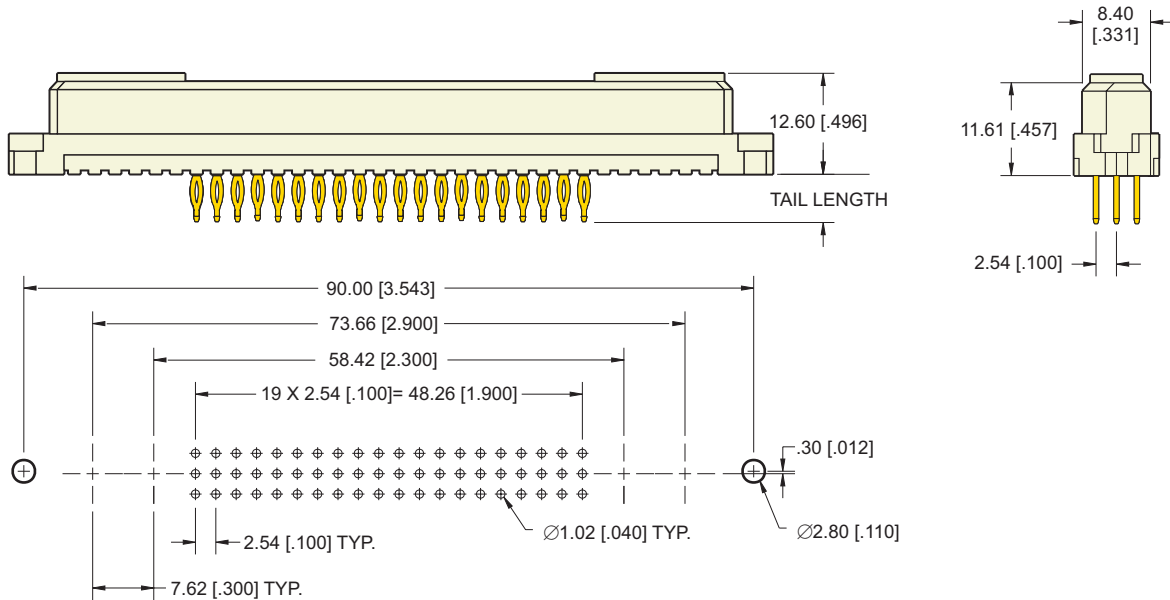

Type M, 60 + 4 Recommended P.C. Board Layout Shown

PART NUMBERING



SERIES CODE
Type M Female DIN

SIGNAL CONTACTS
78, 60, 42, 24, 06

CONTACT ARRANGEMENT

- 1 = a, b, c
- 2 = a, b
- 3 = a, c
- 4 = b, c
- 5 = a
- 6 = b
- 7 = c

MULTI PURPOSE CAVITIES

- 2, 4, 6, 8, 10

MC = Mounting Clips
Blank = No Mounting Clip

TAIL PLATING

- 1 = Tin
- 2 = Gold flash (.200" from pin tip)
- 3 = Gold plate 30μ" (.200" from pin tip)
- 4 = Gold plate 15μ" (.200" from pin tip)

MATING AREA PLATING

- 1 = Class 1
- 2 = Class 2
- 3 = Class 3

TAIL LENGTH

- 1 = 5.00 [.197] Press-Fit
- 2 = 13.00 [.512] Press-Fit
- 4 = 17.00 [.669] Press-Fit
- 5 = 2.92 [.115] Dip Solder
- 6 = 4.06 [.160] Dip Solder
- 7 = 13.00 [.512] Dip Solder Wire Wrap