

# Type M, Right Angle Male DIN

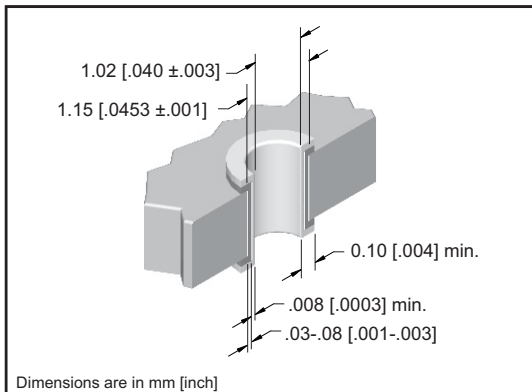

## DIN 41612 SPECIFICATION

Temperature Range	-55°C to +125°C	
Insulator Material	PBT 30% Glass Filled UL 94 V-0 Rated	
Contact Material:	Copper Alloy	
Contact Plating / Performance	Level 1	≥ 500 Mating Cycles
	Level 2	≥ 400 Mating Cycles
Per DIN 41612	Level 3	≥ 50 Mating Cycles
Contact Resistance	≤ 20m Ω	
Insulation Resistance	≥ 10 <sup>12</sup> m Ω at 100 VDC	
Dielectric Strength	≤ 1000 VDC	
Current Range at Ambient Temp. Of	+20C	3.0 Amp
	+70C	2.0 Amp
	+100C	1.0 Amp
Insertion Force (N)	6 contacts @ ≤5      60 contacts @ ≤57 24 contacts @ ≤22    78 contacts @ ≤74 42 contacts @ ≤40	
Withdrawal Forces Per Contact (N)	> .15	



DRILLED HOLE DIAMETER	PLATING THICKNESS	HOLE DIAMETER	PAD DIAMETER	INSERTION FORCE PER PIN	WITHDRAWAL FORCE PER PIN
1.15 [.0453]	Copper .03-.08 [.001-.003] Tin .008 [.0003]min.	After Plating .040±.003	1.65 [.065]	40 lbs. Max.	10 lbs. Min.

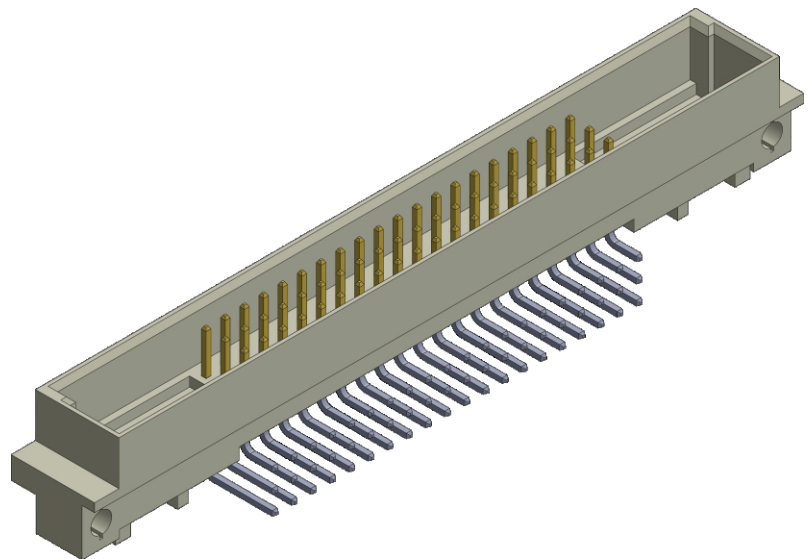

## APPROVALS



Recognized under the recognized component Program of Underwriters Laboratories, Inc.  
File Numbers: E176234

**IEC 60603-2 Standard**

## Bellcore GR 1217 CORE

Connectors are available that meet the requirements of Bellcore GR 1217-CORE. Please consult factory for ordering information.

# Type M, Right Angle Male DIN

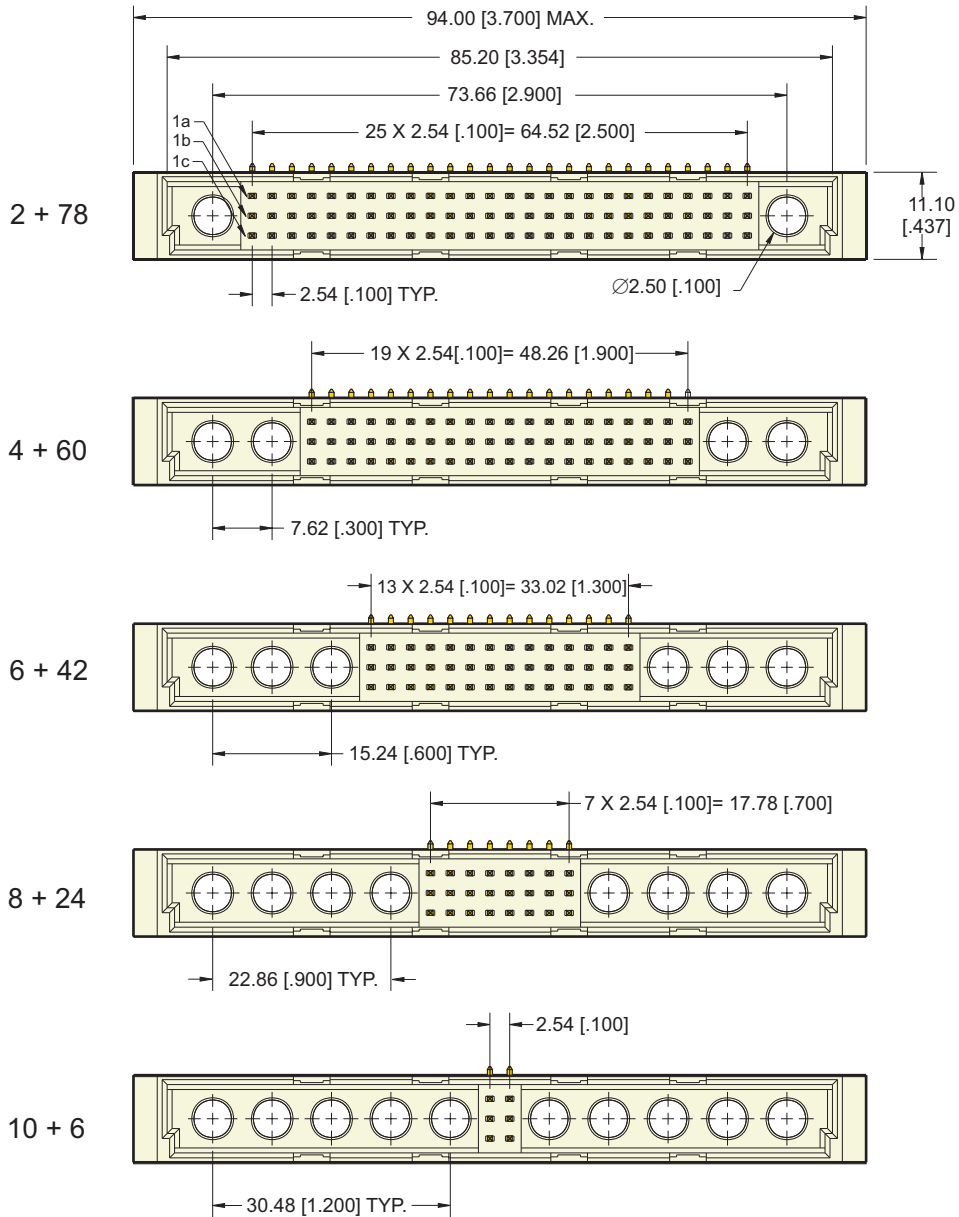

## COAXIAL CONTACTS

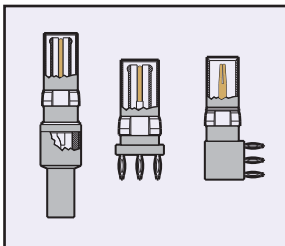

## HIGH POWER CONTACTS

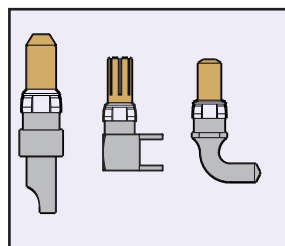

## HIGH CURRENT CONTACTS

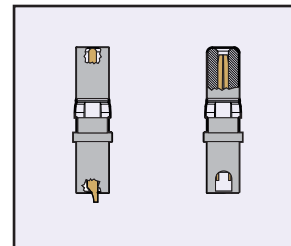

# Type M, Right Angle Male DIN

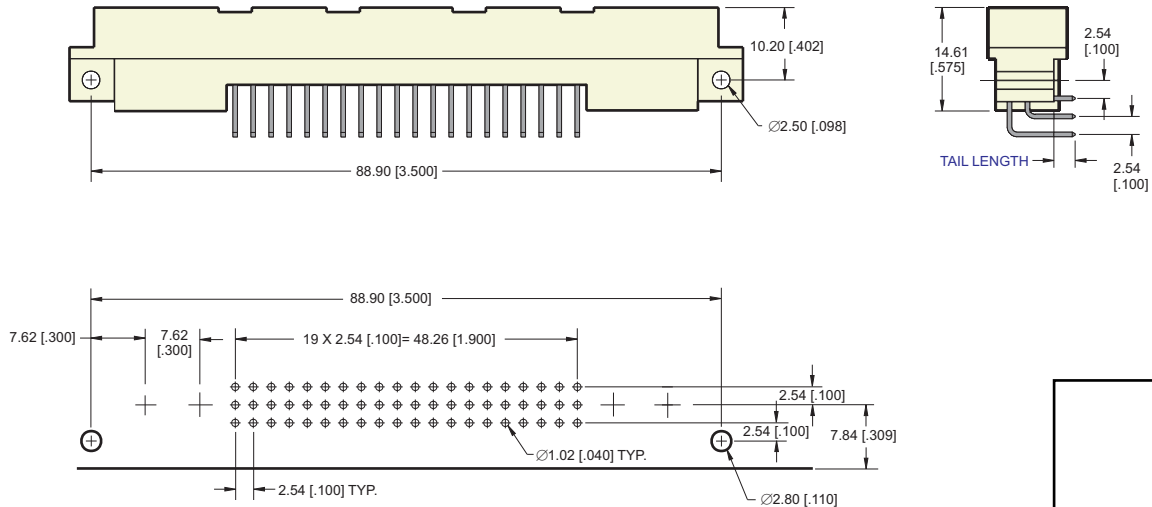

Type M, 60 + 4 Recommended P.C. Board Layout Shown

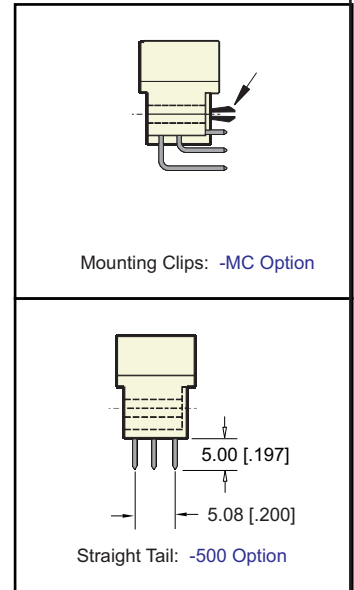

## PART NUMBERING

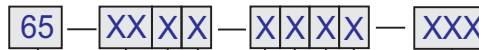

**SERIES CODE**  
Type M Male DIN

**SIGNAL CONTACTS**

- 78
- 60
- 42
- 24
- 06

**CONTACT ARRANGEMENT**

- 1 = a, b, c
- 2 = a, b
- 3 = a, c
- 4 = b, c
- 5 = a
- 6 = b
- 7 = c

**MULTI PURPOSE CAVITIES**

- 2, 4, 6, 8, 10

MC = Mounting Clips  
Blank = No Mounting Clip  
500 = Straight Tail

**TAIL PLATING**

- 1 = Tin
- 2 = Gold flash (.200" from pin tip)
- 3 = Gold plate 30µ" thick min. (.200" from pin tip)

**MATING AREA PLATING**

- 1 = Class 1
- 2 = Class 2
- 3 = Class 3

**TAIL LENGTH**

- 1 = 2.92 [.115] Right Angle
- 4 = 3.30 [.130] Right Angle
- 8 = 5.00 [.197] Straight Tail

**EMLB / LMEB CONTACT**

- 1 = Required (consult factory)
- 2 = Not Required (standard contact loading)