

Type R, R/2, R/3 Vertical Male DIN

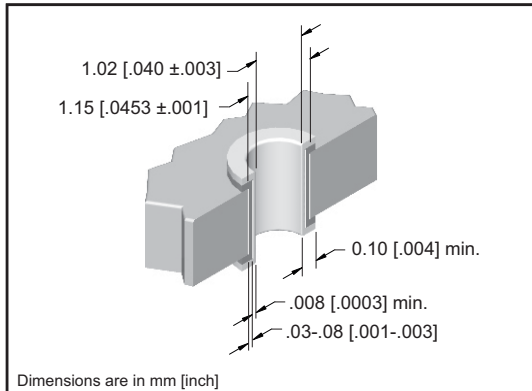

DIN 41612 SPECIFICATION

Temperature Range	-55°C to +125°C	
Insulator Material	PBT 30% Glass Filled UL 94 V-0 Rated	
Contact Material:	Copper Alloy	
Contact Plating / Performance	Level 1	≥ 500 Mating Cycles
	Level 2	≥ 400 Mating Cycles
Per DIN 41612	Level 3	≥ 50 Mating Cycles
Contact Resistance	≤ 20m Ω	
Insulation Resistance	≥ 10 ¹² m Ω at 100 VDC	
Dielectric Strength	≤ 1000 VDC	
Current Range at Ambient Temp. Of	+20C	3.0 Amp
	+70C	2.0 Amp
	+100C	1.0 Amp
Insertion Force (N)	20 contacts @ ≤18	48 contacts @ ≤45
	30 contacts @ ≤28	64 contacts @ ≤60
	32 contacts @ ≤30	96 contacts @ ≤90
Withdrawal Forces Per Contact (N)	> .15	



DRILLED HOLE DIAMETER	PLATING THICKNESS	HOLE DIAMETER	PAD DIAMETER	INSERTION FORCE PER PIN	WITHDRAWAL FORCE PER PIN
1.15 [.0453]	Copper	After Plating .040±.003	1.65 [.065]	40 lbs. Max.	10 lbs. Min.
	Tin .008 [.0003]min.				

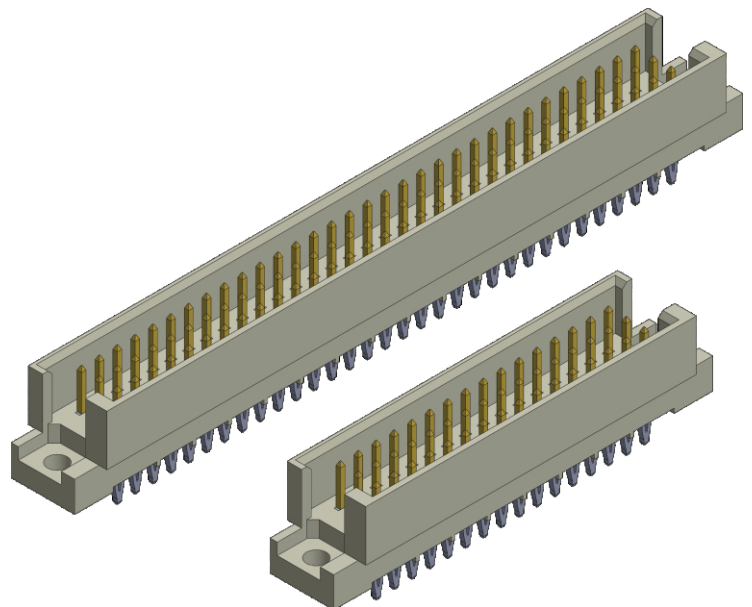

APPROVALS



Recognized under the recognized component Program of Underwriters Laboratories, Inc.
 File Numbers: E176234

IEC 60603-2 Standard

Bellcore GR 1217 CORE

Connectors are available that meet the requirements of Bellcore GR 1217-CORE. Please consult factory for ordering information.

Type R, R/2, R/3 Vertical Male DIN



Type R (96 Positions), R Extended (120 and 150 Positions)

Dim.	96 Positions	120 Positions	150 Positions
A	78.74 [3.100]	99.06 [3.900]	124.46 [4.900]
B	85.20 [3.354]	105.51 [4.154]	130.91 [5.154]
C	90.00 [3.543]	110.31 [4.343]	135.71 [5.343]
D	95.00 [3.740]	115.32 [4.540]	140.72 [5.540]

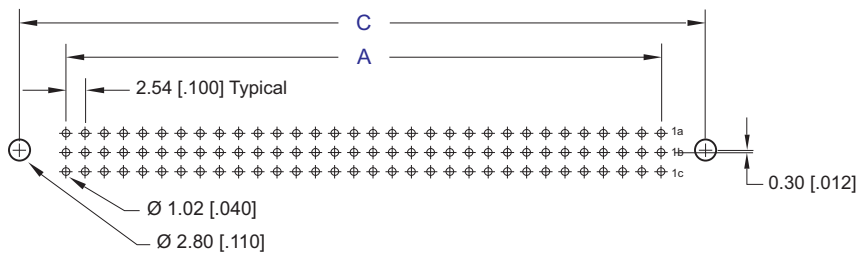
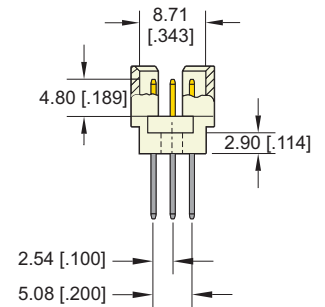
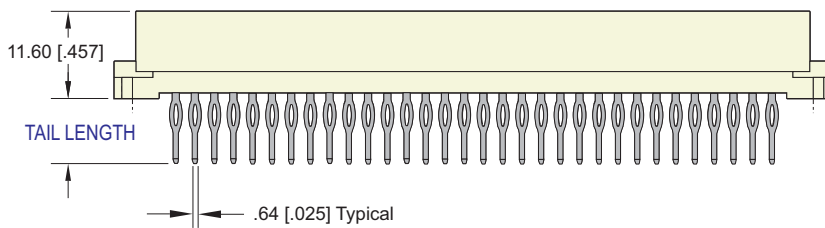
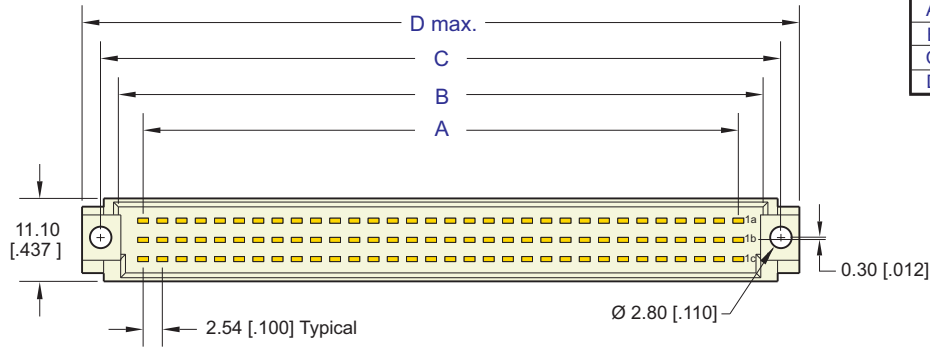

Recommended P. C. Board Layout

TAIL LENGTH OPTIONS

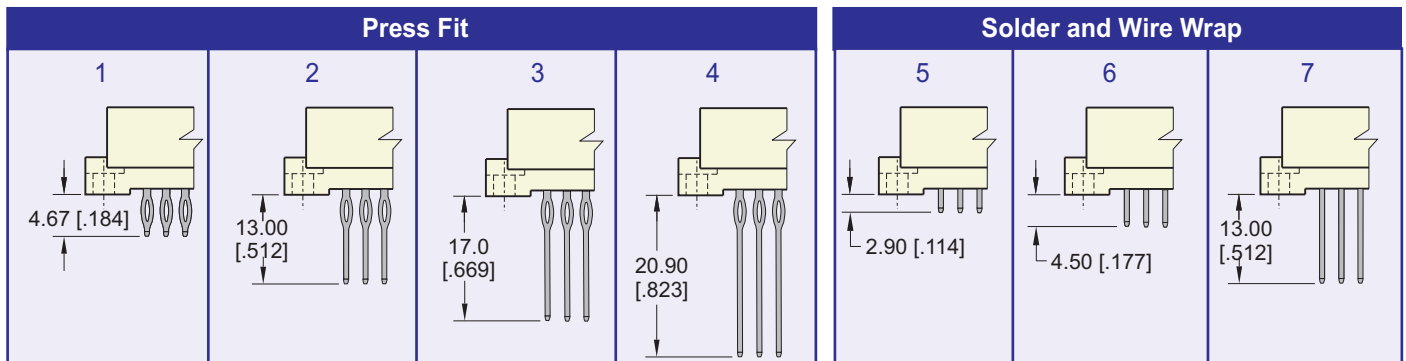

Type R/2, 48 Positions

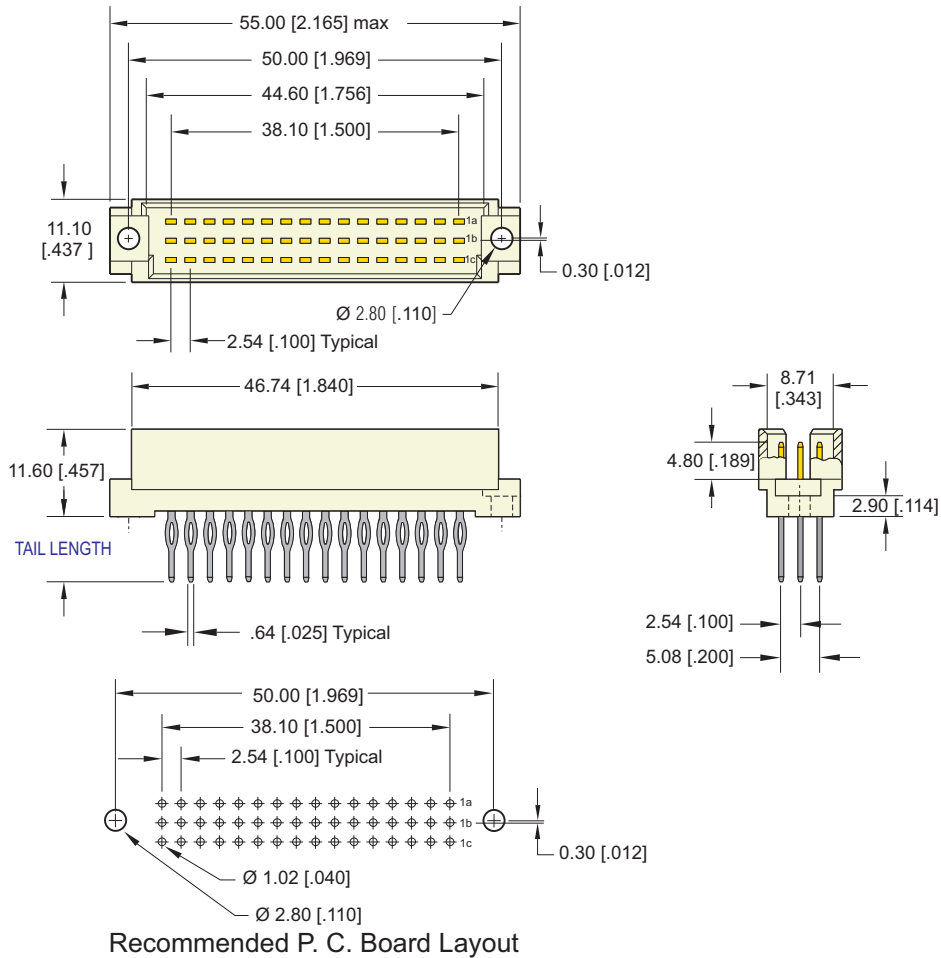

Recommended P. C. Board Layout

PART NUMBERING



SERIES CODE
Type R, R/2, R/3 and R Extended

NO. CONTACT POSITIONS

- 0 = R/3 (30 positions) not shown
- 1 = R/2 (48 positions)
- 2 = R (96 positions)
- 3 = R Extended (150 positions)
- 4 = R Extended (120 positions)

NUMBER OF CONTACTS

- 0 = 30
- 1 = 16
- 2 = 32
- 3 = 48
- 4 = 64
- 5 = 96
- 6 = 150
- 7 = 120

CONTACT ARRANGEMENT

- 1 = Row A, B, and C fully populated
 - 2 = Row A and B fully populated, Row C not populated
 - 3 = Row A and C fully populated, Row B not populated
 - 4 = Row B and C fully populated, Row A not populated
- Consult Factory for other Loading Options

Note: Press Fit Connectors required a press in tool.
Consult Factory for Press In Tool information.

MC = Mounting Clip
Blank = No Mounting Clip

TAIL PLATING

- 1 = Tin
- 2 = Gold flash (.200" from pin tip)
- 3 = Gold plate 30µ" (.200" from pin tip)
- 4 = Gold plate 15µ" (.200" from pin tip)

MATING AREA PLATING

- 1 = Class 1
- 2 = Class 2
- 3 = Class 3

TAIL LENGTH

- 1 = 4.67 [.184] Press-Fit
- 2 = 13.00 [.512] Press-Fit
- 3 = 17.00 [.669] Press-Fit
- 4 = 20.90 [.823] Press-Fit
- 5 = 2.90 [.114] Dip Solder
- 6 = 4.50 [.177] Dip Solder
- 7 = 13.00 [.512] Dip Solder Wire Wrap

CONTACT TYPE

- 1 = For all Press Fit Connectors
(Consult Factory if EM/LB Contact Required)
- 1 = Solder Version Requiring EM/LB Contacts
(Consult Factory)
- 2 = Solder Versions (Standard Contacts)