

2.0mm FutureBus 5 Row Female Power Right Angle Mono Block

MONO BLOCK

Contact	Dim A
010	11.95
020	23.95
030	35.95
040	47.95
050	59.95
060	71.95
070	83.95
080	95.95

Specifications

- Insulator Material: High Temperature Thermoplastic Glass Filled 94V-O, UL Recognized, color black.
- Contact Material: High Performance Beryllium Copper
- Contact Plating: Class 1: 1000 cycles or Class 2: 500 cycles
- Mating Insertion Force: 0.45N (0.10 lbs) max. per contact
- Unmating Withdrawal Force: 0.20N (0.045 lbs) min. per contact
- Compliant Insertion Force: 100N (22.50 lbs) max. per contact
- Compliant Withdrawal Force: 20N (4.50 lbs) min. per contact
- Insulation Resistance: 1000 M ohms min. @ 500v
- Contact Resistance: 30 m ohms max. @ DC 100mA
- Current Rating: 3 Amp @ 20°C per contact
- Operating Temperature: -55°C To +225°C
- UL File Numbers: E 176234, IEEE 896.10 FutureBus+

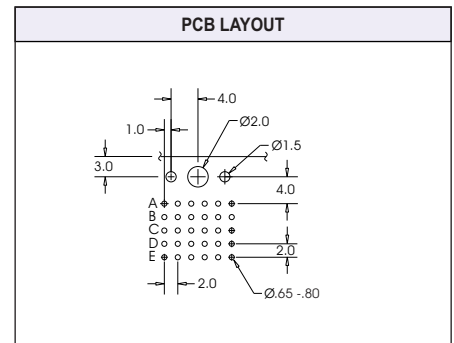
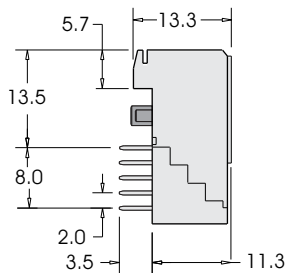
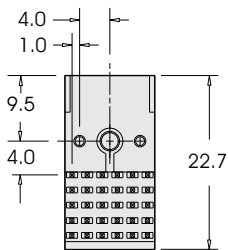
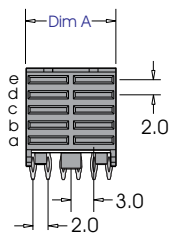
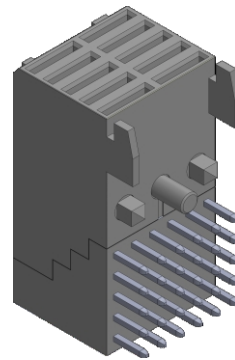

PART NUMBERING

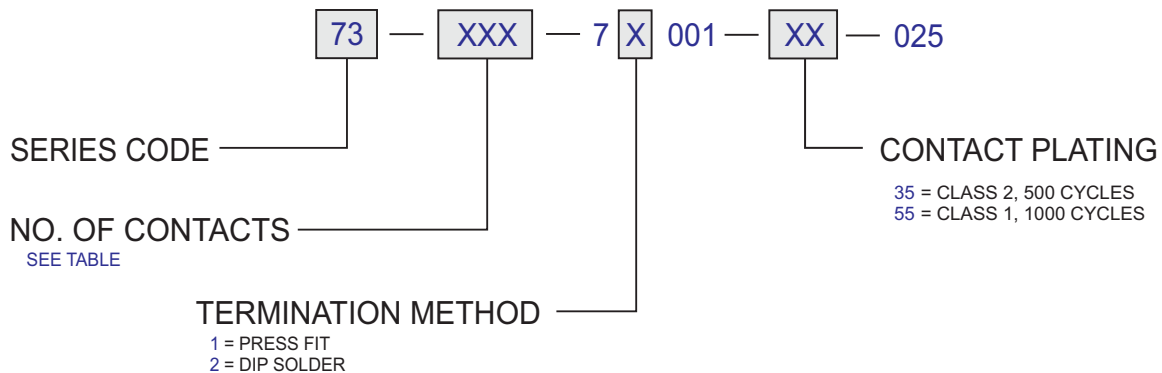

2.0mm FutureBus 4 Row Female Power Right Angle Mono Block

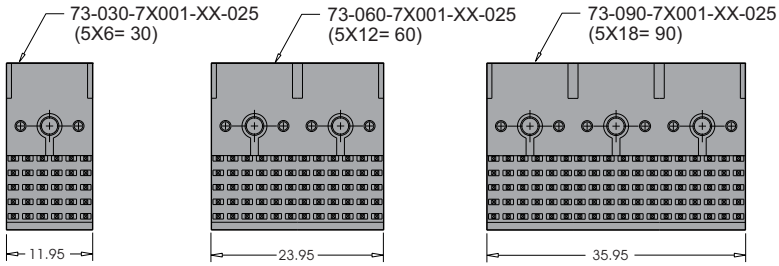
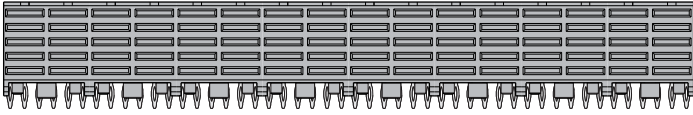

73-120-7X001-XX-025 (5X24=120)

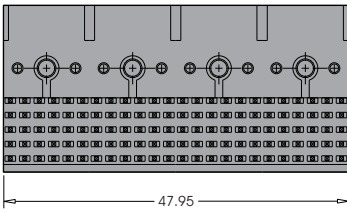

73-150-7X001-XX-025 (5X30=150)

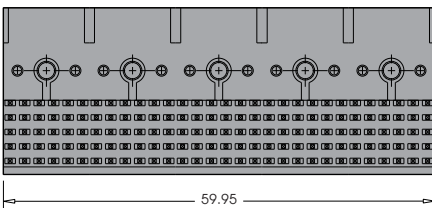

73-180-7X001-XX-025 (5X36=180)

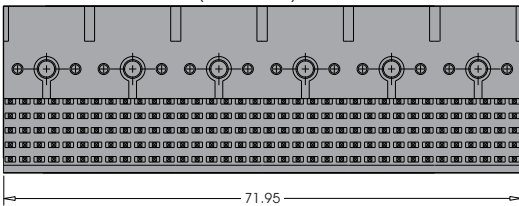

73-210-7X001-XX-025 (5X42=210)

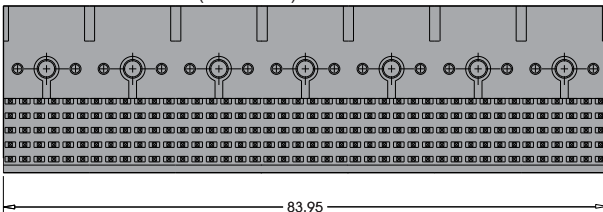

73-240-7X001-XX-025 (5X48=240)

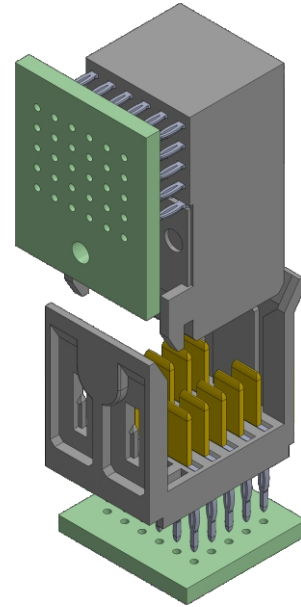
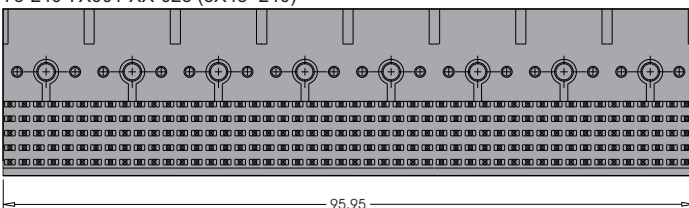

PRESS-FIT WITHDRAWAL
20 N MIN./ CONTACT

PRESS-FIT INSERTION FORCE:
100 N MAX./ CONTACT

UNMATING WITHDRAWAL:
0.20 N MIN./ CONTACT

MATING INSERTION FORCE:
0.45 N MAX./ CONTACT

