

# Type B, B/2, B/3 Vertical Female DIN

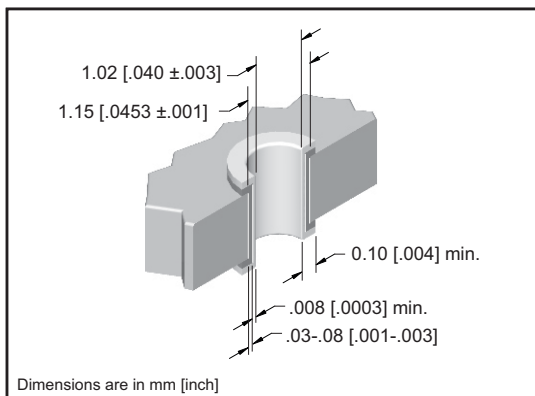

DIN 41612 SPECIFICATION	
Temperature Range	-55°C to +125°C
Insulator Material	PBT 30% Glass Filled UL 94 V-0 Rated
Contact Material:	Copper Alloy
Contact Plating / Performance	Level 1 ≥ 500 Mating Cycles Level 2 ≥ 400 Mating Cycles Level 3 ≥ 50 Mating Cycles
Contact Resistance	≤ 20m Ω
Insulation Resistance	≥ 10 <sup>12</sup> m Ω at 100 VDC
Dielectric Strength	≤ 1000 VDC
Current Range at Ambient Temp. Of	+20C 3.0 Amp +70C 2.0 Amp +100C 1.0 Amp
Insertion Force (N)	20 contacts @ ≤18      32 contacts @ ≤30 30 contacts @ ≤28      64 contacts @ ≤60
Withdrawal Forces Per Contact (N)	> .15



DRILLED HOLE DIAMETER	PLATING THICKNESS	HOLE DIAMETER	PAD DIAMETER	INSERTION FORCE PER PIN	WITHDRAWAL FORCE PER PIN
1.15 [.0453]	Copper .03-.08 [.001-.003]	After Plating .040±.003	1.65 [.065]	40 lbs. Max.	10 lbs. Min.
	Tin .008 [.0003]min.				

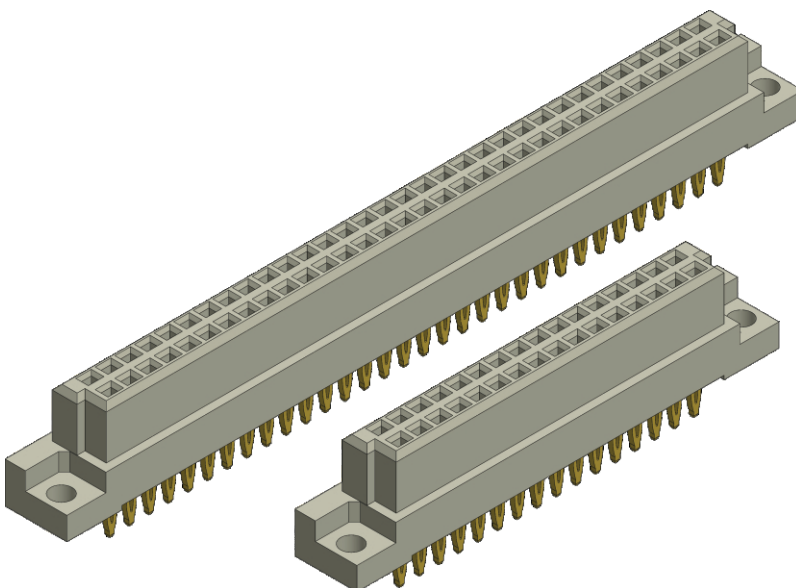

## APPROVALS



Recognized under the recognized component Program of Underwriters Laboratories, Inc.  
File Numbers: E176234

## IEC 60603-2 Standard

## Bellcore GR 1217 CORE

Connectors are available that meet the requirements of Bellcore GR 1217-CORE. Please consult factory for ordering information.



# Type B, B/2, B/3 Vertical Female DIN

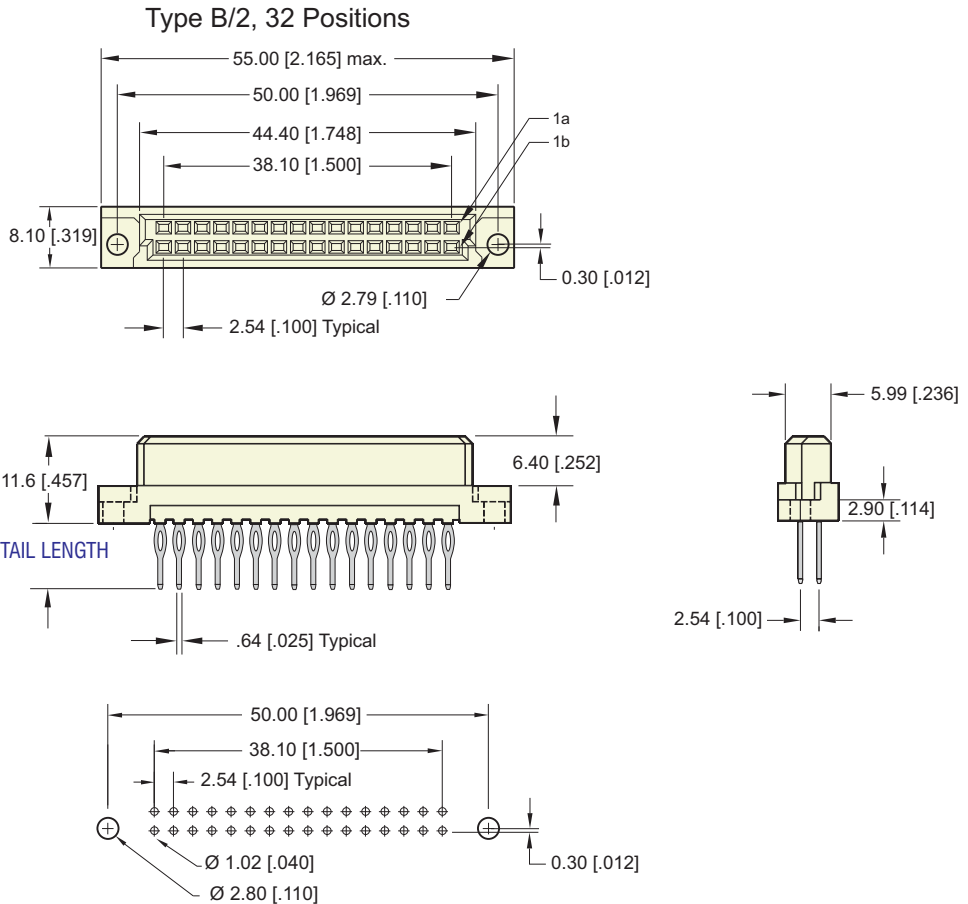

Recommended P. C. Board Layout

## PART NUMBERING

