

1.27mm [0.050"] 160 Contacts, I/O Connector Vertical



PLUG

SPECIFICATION

- Housing: liquid crystal polymer (LCP), glass-filled polymer, UL 94V-O
- Contact: phosphor bronze alloy
- Plating:
 - Terminals= Contact Area: Gold over Nickel
 - Tail Area: Gold or Tin over Nickel
 - Shields=150µ" min. bright Tin over Nickel all over Copper flash
- Operating Temperature: -20 to +80°C
- Voltage: 40V
- Current: 1.0A
- Contact Resistance: 20 milliohms max.
- Dielectric Withstanding Voltage: 500V
- Insulation Resistance: 100 Megohms min.
- Contact Insertion Force: 60g max.
- Mating Force: 50g nom.
- Unmating Force: 20g min.

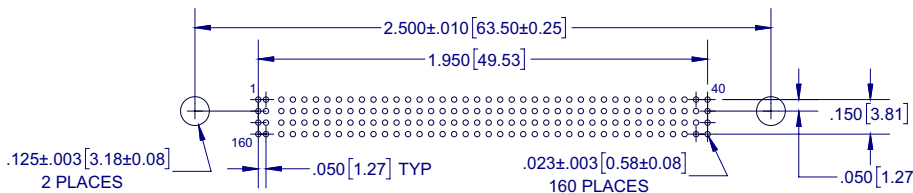
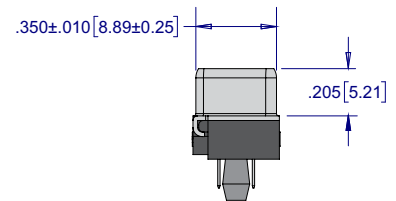
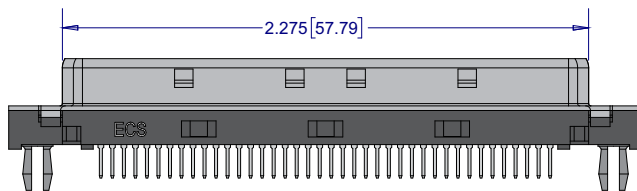
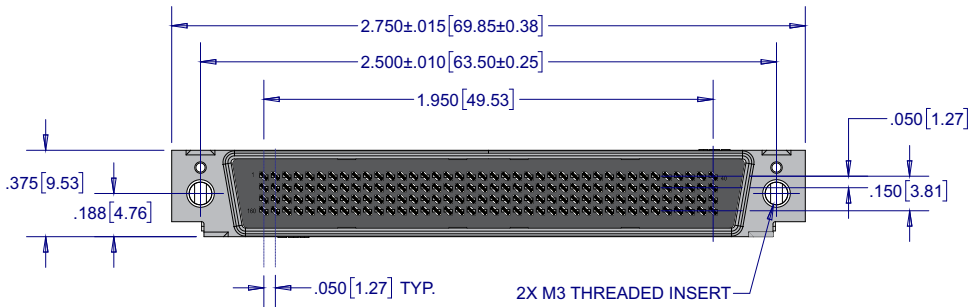

PART NUMBERING

A18 40 - P 1 4 - XX

SERIES CODE

.050" X .050" Centers

NO. POSITION

MOUNTING STYLE

CONNECTOR - BOARD
4 = M3 UNC - Board Lock Inserts

Consult Factory for other Mounting Styles

PLATING

50µ" Nickel Underplate

Mating Area	Tail
03 = Flash Au	Flash Au
05 = Flash Au	100µ" Tin
20 = 15µ" Gold	100µ" Tin
30 = 30µ" Gold	100µ" Tin
60 = 30µ" Gold	Flash Au

