

# 1.27mm [0.050"] 160 Contacts, I/O Connector Vertical



## RECEPTACLE

### SPECIFICATION

- Housing: liquid crystal polymer (LCP), glass-filled polymer, UL 94V-O
- Contact: beryllium copper alloy
- Plating:
  - Terminals= Contact Area: Gold over Nickel
  - Tail Area: Gold or Tin over Nickel
  - Shields=150µ" min. bright Tin over Nickel all over Copper flash
- Operating Temperature: -20 to +80°C
- Voltage: 40V
- Current: 1.0A
- Contact Resistance: 20 milliohms max.
- Dielectric Withstanding Voltage: 500V
- Insulation Resistance: 100 Megohms min.
- Contact Insertion Force: 60g max.
- Mating Force: 50g nom.
- Unmating Force: 20g min.

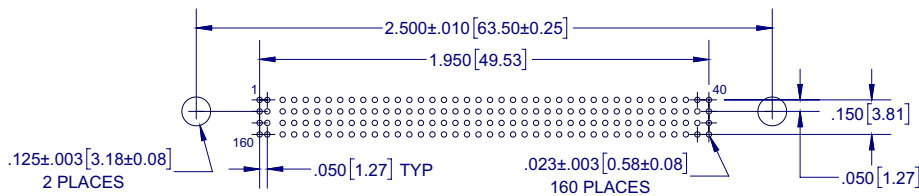
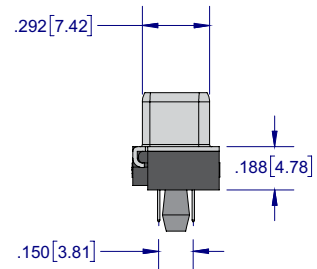
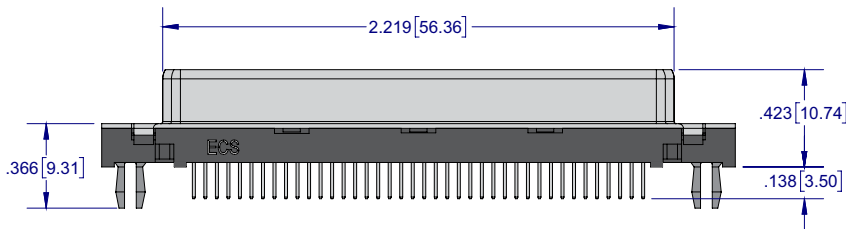
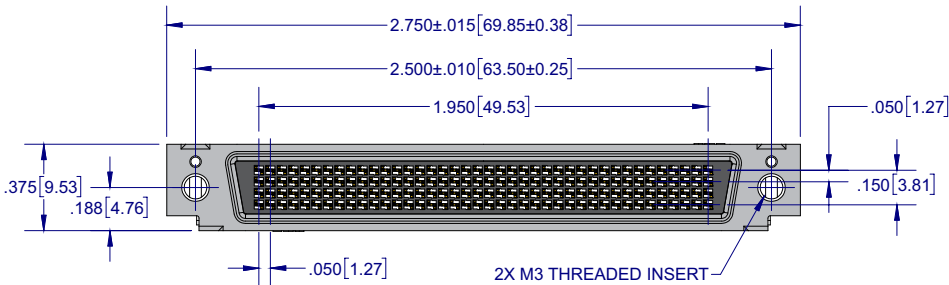

## PART NUMBERING

A19 40 — R 1 4 — XX

### SERIES CODE

.050" X .050" Centers

### NO. POSITION

### MOUNTING STYLE

CONNECTOR - BOARD  
4 = M3 UNC - Board Lock Inserts

Consult Factory for other Mounting Styles

### PLATING

50µ" Nickel Underplate

Mating Area	Tail
03 = Flash Au	Flash Au
05 = Flash Au	100µ" Tin
20 = 15µ" Gold	100µ" Tin
30 = 30µ" Gold	100µ" Tin
60 = 30µ" Gold	Flash Au

